

Amkette Industries



STEEL & WOOD Laboratory Furniture



- Wood Furniture
- Steel Furniture
- Steel & Wood Furniture
- Fume Hoods



The Company Amkette Industries Pvt. Ltd. is a company within ANM Alliance Group which is one of the largest company in Laboratory Business. Amkette Industries was established in April, 2010 under the Indian companies Act, havin manufacturing area with an overall supportive infra-structural area of 10,000 sq. ft. which is fully equipped with the latest manufacturing equipment.

The strategic location of the facility at the outskirts just outside Mumbai (Bombay) which offers a strong infrastrutre being financial hub of India and conveniently accessible Sea & Airports. This benefits our clients in India and overseas enables Amkette Industries to offer a competitive pricing structure.

All Amkette Industries products are manufactured under one roof and subsequently all metal forming, finishes, extrusions, form rolling and assembly are completed in-house. With the result that specific requirements of our clients can be incorporated into a proposed design/ product requirement. The capacity of the manufacturing facility results into timely delivery and prompt technical support by a net of skilled persons across the country.

Amkette Industries products are under third party testing/ design appraisals, to achieve conformance with the following international criteria's and standards: We have a team strength of over 150 employees across country with offices Nationwide. Highly Qualified Engineers & architectures from our team who design & execute our project having worldclass projects.

Our Vision

To be the finest skills - based total solution provider for turnkey projects, delighting our customers.

Our Mission

The management team will focus on delivering great value to customers by developing high caliber professional skills in core competence areas and representing world class instrumentation and automation products.

Our Core Competencies

- Project management
- Systems integration and maintenance
- Delivering the best solutions for MEP

Our Values

Integrity and honesty.

Passion for customers, for our partners and technology.

Openness and respectfulness.

Taking on big challenges and seeing them through.

Constructive self-criticism, self-improvement and personal excellence.

Accountability to customers, partners and employees for commitments, results and quality.

H-Frame Laboratory Furniture



The steel and wood lab bench includes two kinds of structure. H-frame and C-frame. H-frame works better with heavy bearing.

It selects 40*60/30*30mm square steel, phosphating and pickling treatment for surface, epoxy resin powder paint, no prominent section-block, smooth charm, outstanding acid-proof and alkali-proof performance.

Stainless steel and rubber adjustable feet, it's damping-proof, shippery proof, corrosive-proof. It's with shock absorbing function and with better weight bearing. The adjustable height is 30~50mm and it's bearing capacity can reach above 150KG.

Steel H-frame can meet the requirements of using large-scale precision instruments and can hold more than 500KG weight.

Worktop can choose lab-grade phenolic resins, or epoxy resin worktop, or ceramic worktop, or artificial stone worktop and stainless steel as worktop.



C-Frame Laboratory Furniture



C frame is more flexible with simple structure.

It selects 60*40/60*30mm square steel, phosphating and pickling treatment for surface, epoxy resin powder paint, no prominent section-block, smooth charm, outstanding acid-proof and alkali-proof performance.

Stainless steel and rubber adjustable feet, it's damping-proof, shippery proof, corrosive-proof. It's with shock absorbing function and with better weight bearing. The adjustable height is 30~50mm and it's bearing capacity can reach above 150KG.

C-frame can choose suspended cabinet and push drawer structure.

They are easy to be cleaned, assembled and dismental.



Steel Laboratory Furniture



It's designed by CAD and digital-precision made. As a single unit it can be assembled freely with a better formation to fit into your lab space. It's with good weight bearing, long lifetime and excellent cost performance. It can meet your space requirement for laboratory.

The workstation body is using selected 1.0 mm thickness first-class cold/galvanized steel sheet, automatic skimmers forming, phosphating and pickling treatment for surface, epoxy resin powder, no prominent section block, smooth charm, outstanding acid-proof and alkali-proof performance.

Worktop can choose lab-grade phenolic resins worktop, or epoxy resin worktop, or ceramic worktop, or artificial stone worktop and stainless steel as worktop.



Laboratory Fume Hood



Fume hood is one of the necessary facilities for laboratory. It will discharge poisonous, harmful, flavourous air caused in experiment very promptly by means of effective local ventilation type. It will ensure the physical and psychological health for operator. After cooperating with authority organization in this field, Our company has developed various products with different functions and designs. It can meet higher requirements from different customers.

Main type: standard fume hood, walk-in fume hood, up-table fume hood, mending wind fume hood, combined fume hood and fume hood with acid storage

- Standard Fume Hood
- Fume Hood with Acid Storage Cabinet
- Walk-in Fume Hood
- Up-Table Fume Hood
- Mending Fume Hood
- Combined Fume Hood



C -Frame Laboratory Furniture

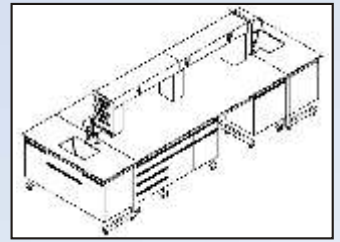
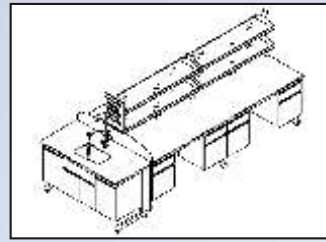
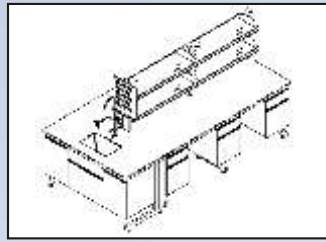
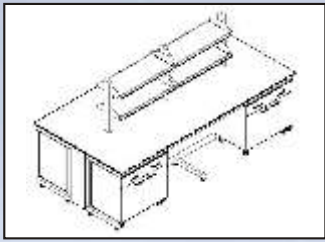

Base Cabinets

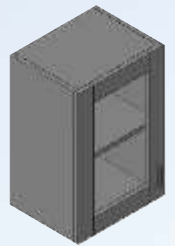
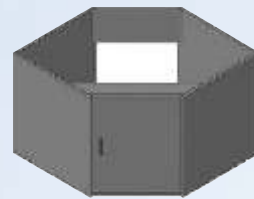
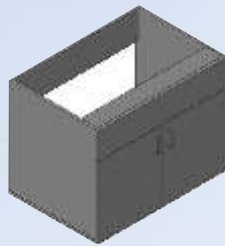
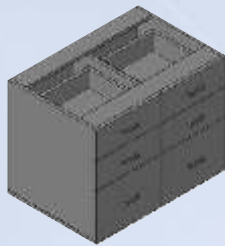
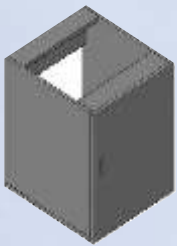

Storage Cabinet

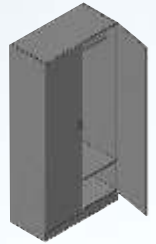
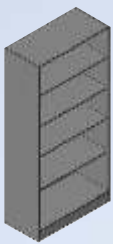

Floor Steel Laboratory Furniture

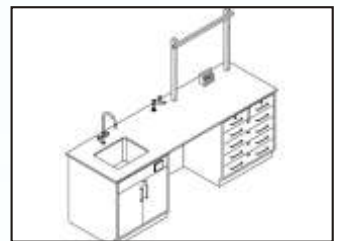
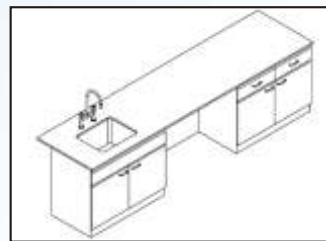
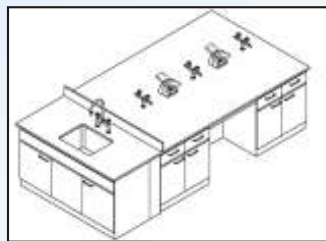
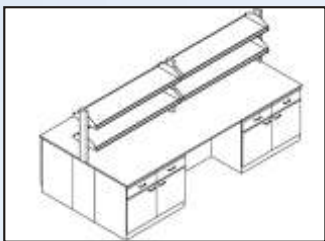

Standard & Walk-in Fume Hood

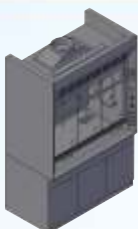



Amkette Industries

Pvt. Ltd.

Factory:

ANM Towers,
Plot No. A-141, Road No. 23,
Wagle Industrial Area,
Thane - 400 604. INDIA.

Regd. Office:

B-27, Shri Ram Ind. Estate
13, G. D. Ambekar Marg
Wadala, Mumbai - 400 031
INDIA

Tel.: 91-22 - 2416 1544 - 47

Fax: 91-22 - 2418 1770

Email: info@anmalliance.com

URL: www.anmalliance.com